

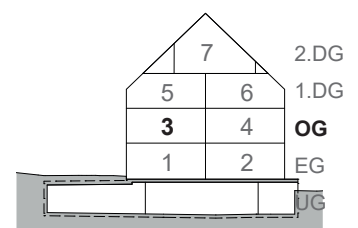

WOHNUNG 3

4 1/2-Zimmer-Wohnung

| | |
|------------------|----------------------|
| Bruttowohnfläche | 121.5 m ² |
| Nettowohnfläche | 116.0 m ² |
| Balkon | 12.5 m ² |
| Abstell Balkon | 2.0 m ² |
| Keller | 10.0 m ² |

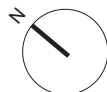

l_m l₁ l₂ l₃ l₄ l₅

MST. 1:100